

Reveal[®] Q+ for DON

DOWNLOAD AND READ KIT INSTRUCTIONS COMPLETELY BEFORE PERFORMING TEST.



Materials Provided:

25 Reveal[®] Q+ for DON test strips
25 red sample dilution cups
25 clear sample cups
02 bottles of sample diluent

Product Number: 8385

Threshold: 0.3–30 ppm

Testing time: 3 minutes

Call 800.234.5333 to order or visit [Neogen.com](https://www.neogen.com)

Procedure



1 Prepare by entering the QR code into the Raptor[®] reader.



2 Obtain a representative sample. Grind and weigh out a 10 g sample.



3 Add 100 mL distilled or deionized water to the sample.*



4 Shake vigorously for 3 minutes, or blend for 1 minute.



5 Allow to settle, then filter collecting a minimum 3 mL filtrate.

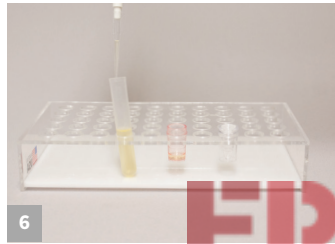

6 Add 100 µL sample extract to the red dilution cup.

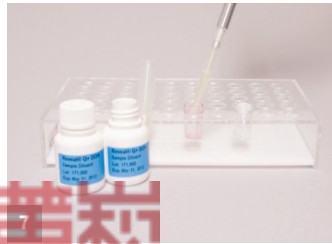

7 Add 1,000 µL of the sample diluent to the red dilution cup and mix by pipetting up and down 5 times.

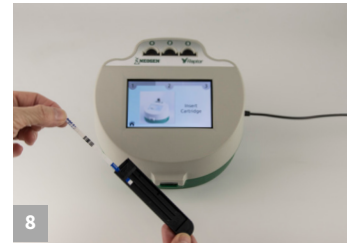

8 Insert the strip into the Raptor cartridge.

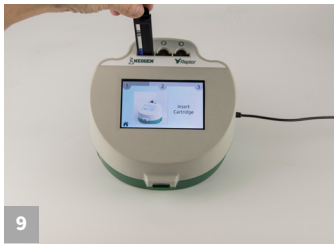

9 Insert the cartridge into the Raptor reader.



10 Add 400 µL the sample from the red dilution cup to the back of the Raptor cartridge. Reader will start automatically.



11 Results shown on the Raptor reader.

*Samples greater than 6 ppm must be diluted and rerun.



Call 800.234.5333 to order or visit Neogen.com

Reveal[®] Q+ for DON

Product Number: 8385

Ordering Information

8385 Reveal Q+ for DON
9680 Raptor system
9681 Raptor cartridges

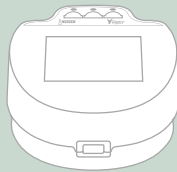

Materials Recommended, Not Provided

Neogen #	Item Description
9428, 9428B	Sample collection cups with lids 125 mL
9421, 9421B	Sample collection tubes with caps
9420, 9429, 9519	Filter syringes, Whatman #4 filter paper or equivalent
9330	Centrifuge, mini
9172	Microcentrifuge tubes
9448, 9447	Dispensing pump or graduated cylinder
9401, 9453	Agri-grind grinder or equivalent
9427	Scale capable of weighing 5–50 g ± 0.1 g
9426, 9452	Timer
9475	Reveal sample cup rack
9463	Pipettor, 100–1000 µL
9464, 9487	Pipette tips, 100–1000 µL
9693	Pipettor, 400 µL
–	Distilled or deionized water

Test with Confidence

Neogen[®] introduces Reveal[®] Q+ for DON, an easy-to-use, rapid, quantitative lateral flow test that provides unparalleled accuracy in only three minutes.

Reveal Q+ for DON is the product of Neogen's innovative technology that yields accurate and reproducible quantitative results.

The Raptor[®] reader allows the user to simply add sample and walk away — the instrument controls the volume, temperature, and timing of the assay. The system allows three samples to be run at one time.

- Simple procedure — just add sample
- Fast time to result
- Eliminate operator errors

